



DEPARTMENT OF THE ARMY  
CAMP STANLEY STORAGE ACTIVITY, MCAAP  
25800 RALPH FAIR ROAD, BOERNE, TX 78015-4800

May 3, 2012

U-029-12

[REDACTED]  
7850 Smokey View  
Boerne, TX 78015

SUBJECT: Sampling of Water Well JW-31, Located at 7850 Smokey View

[REDACTED],  
Camp Stanley Storage Activity (CSSA) collected a groundwater sample from your well (JW-31) on 3/7/12. This sample was submitted to a laboratory contracted by CSSA's environmental contractor for volatile organic compound (VOC) analysis. This letter provides you with the VOC data from the laboratory results and a formal thank you for your assistance in this groundwater monitoring effort.

Based on the analytical data, no VOCs related to CSSA's groundwater investigation were identified in the water sample from your well. Results from the laboratory analysis are provided as an attachment for the above sampling event. The information you requested concerning your well is also attached.

As part of the ongoing CSSA environmental program, we are continuing to investigate and cleanup VOC source areas on the installation and to track these compounds in groundwater on- and off-post. As part of this effort, your well is scheduled to be sampled again in December 2012.

Again, we would like to thank you for your cooperation. We remain committed to making sure your water is safe to use and keeping you informed. If you have any questions concerning this letter, please contact Gabriel Moreno-Fergusson, Environmental Program Manager, at (210) 295-7014.

Sincerely,

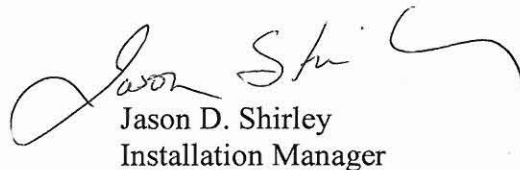
  
Jason D. Shirley  
Installation Manager

Enclosure

cc: Mr. Greg Lyssy, EPA Region 6  
Mr. Kirk Coulter, TCEQ Central Office  
Mr. Henry Karnei, TCEQ Region 13  
Ms. Kyle Cunningham, San Antonio Metropolitan Health Dist.  
Ms. Julie Burdey, Parsons

AFCEE  
ORGANIC ANALYSES DATA SHEET 2  
RESULTS

Analytical Method: EPA 8260B      Preparatory Method: 5030B      AAB #: 120313AN-164939  
 Lab Name: APPL, Inc      Contract #: \*G012  
 Field Sample ID: JW-31      Lab Sample ID: AY56675      Matrix: Water  
 % Solids: NA      Initial Calibration ID: N120309  
 Date Received: 09-Mar-12      Date Prepared: 13-Mar-12      Date Analyzed: 13-Mar-12  
 Concentration Units: ug/L

| Analyte           | MDL  | RL  | Concentration | Dilution | Confirm | Qualifier |
|-------------------|------|-----|---------------|----------|---------|-----------|
| 1,1-DCE           | 0.12 | 1.2 | 0.12          | 1        |         | U         |
| CIS-1,2-DCE       | 0.07 | 1.2 | 0.07          | 1        |         | U         |
| TCE               | 0.05 | 1.0 | 0.05          | 1        |         | U         |
| TETRACHLOROETHENE | 0.06 | 1.4 | 0.06          | 1        |         | U         |
| TRANS-1,2-DCE     | 0.08 | 0.6 | 0.08          | 1        |         | U         |
| VINYL CHLORIDE    | 0.08 | 1.1 | 0.08          | 1        |         | U         |

| Surrogate                      | Recovery | Control Limits | Qualifier |
|--------------------------------|----------|----------------|-----------|
| SURROGATE: 1,2-DICHLOROETHANE- | 92.6     | 69-139         |           |
| SURROGATE: 4-BROMOFLUOROBENZ   | 92.2     | 75-125         |           |
| SURROGATE: DIBROMOFLUOROMETH   | 99.2     | 75-125         |           |
| SURROGATE: TOLUENE-D8 (S)      | 84.8     | 75-125         |           |

| Internal Std                | Qualifier |
|-----------------------------|-----------|
| 1,4-DICHLOROBENZENE-D4 (IS) |           |
| CHLOROBENZENE-D5 (IS)       |           |
| FLUOROBENZENE (IS)          |           |

Comments:

ARF: 67176

Send original copy by certified mail to the Texas Department of Water Resources, P. O. Box 13087, Austin, Texas 78711

**State of Texas**  
**WATER WELL REPORT**

For TDWR use only  
Well No. 68-19-6  
Located on map \_\_\_\_\_  
Received: \_\_\_\_\_

ATTENTION OWNER: Confidentiality Privilege Notice on Reverse Side

1) OWNER Ed. Wiley (D Spain & Waldeck Bldrs.) Address c/o 126 Cottonwood, Boerne, Texas 78006  
(Name) (Street or RFD) (City) (State) (Zip)

2) LOCATION OF WELL:  
County Bexar 2 miles in N direction from Leon Springs  
(N.E., S.W., etc.) (Town)

Driller must complete the legal description to the right with distance and direction from two intersecting section or survey lines, or he must locate and identify the well on an official Quarter- or Half-Scale Texas County General Highway Map and attach the map to this form.

#3

☐ Legal description: Section No. \_\_\_\_\_ Block No. \_\_\_\_\_ Township Jackson Woods  
Abstract No. \_\_\_\_\_ Survey Name \_\_\_\_\_  
Distance and direction from two intersecting section or survey lines \_\_\_\_\_

☐ See attached map.

3) TYPE OF WORK (Check):  
☒ New Well ☐ Deepening  
☐ Reconditioning ☐ Plugging

4) PROPOSED USE (Check):  
☒ Domestic ☐ Industrial ☐ Public Supply  
☐ Irrigation ☐ Test Well ☐ Other \_\_\_\_\_

5) DRILLING METHOD (Check):  
☐ Mud Rotary ☐ Air Hammer ☐ Driven ☐ Bored  
☒ Air Rotary ☐ Cable Tool ☐ Jetted ☐ Other \_\_\_\_\_

6) WELL LOG:

| Date drilled   | DIAMETER OF HOLE |                |            |
|----------------|------------------|----------------|------------|
|                | Dis. (in.)       | From (ft.)     | To (ft.)   |
| <u>6-17-86</u> | <u>8 3/4"</u>    | <u>Surface</u> | <u>237</u> |
|                | <u>6"</u>        | <u>237</u>     | <u>525</u> |

7) BOREHOLE COMPLETION:  
☒ Open Hole ☐ Straight Wall ☐ Underreamed  
☐ Gravel Packed ☐ Other \_\_\_\_\_  
If Gravel Packed give interval ... from \_\_\_\_\_ ft. to \_\_\_\_\_ ft.

| From (ft.) | To (ft.) | Description and color of formation material | Dia. (in.) | New or Used | Steel, Plastic, etc. Perf., Slotted, etc. Screen Mfg., if commercial | Setting (ft.) |     | Casing Screen |
|------------|----------|---|------------|-------------|--|---------------|-----|---------------|
|            |          |   |            |             |  | From          | To  |               |
| 0-24       |          | yellow caliche & cream limestone            | 6 3/8"     |             | steel casing   | 0             | 237 |               |
| 24-35      |          | blue gray shale                             |            |             | 239 feet   |               |     |               |
| 35-52      |          | yellow clay & limestone layers              |            |             |  |               |     |               |
| 52-60      |          | gray shaley limestone                       |            |             |  |               |     |               |
| 60-70      |          | yellow cream colored limestone              |            |             |  |               |     |               |
| 70-82      |          | gray limestone                              |            |             |  |               |     |               |
| 82-90      |          | tannish gray limestone                      |            |             |  |               |     |               |
| 90-100     |          | dark gray shaley limestone                  |            |             |  |               |     |               |
| 100-107    |          | cream colored limestone                     |            |             |  |               |     |               |
| 107-112    |          | light gray limestone                        |            |             |  |               |     |               |
| 112-130    |          | cream colored limestone                     |            |             |  |               |     |               |
| 130-185    |          | white limestone (little water)              |            |             |  |               |     |               |
| 185-210    |          | cream colored limestone                     |            |             |  |               |     |               |
| 210-237    |          | light gray limestone                        |            |             |  |               |     |               |
| 237-257    |          | blue gray lime                              |            |             |  |               |     |               |
| 257-273    |          | light gray lime (little water)              |            |             |  |               |     |               |
| 273-302    |          | gray lime                                   |            |             |  |               |     |               |
| 302-337    |          | blue gray lime                              |            |             |  |               |     |               |
| 337-341    |          | brownish gray lime                          |            |             |  |               |     |               |
| 341-420    |          | cream colored lime (water over 40 gpm)      |            |             |  |               |     |               |
| 420-448    |          | blue gray lime                              |            |             |  |               |     |               |
| 448-455    |          | greenish gray chalky limestone              |            |             |  |               |     |               |
| 455-462    |          | gray limestone & oyster shells              |            |             |  |               |     |               |
| 462-476    |          | white limestone (Cow Creek)                 |            |             |  |               |     |               |
| 476-494    |          | tan limestone                               |            |             |  |               |     |               |
| 494-509    |          | brown-tan sandstone                         |            |             |  |               |     |               |
| 509-523    |          | gray limestone                              |            |             |  |               |     |               |
| 523-525    |          | green limestone (Pine Island Shale)         |            |             |  |               |     |               |

CEMENTING DATA  
Cemented from 0 ft. to 237 ft.  
Method used Readymix Grout- 7sk.  
Cemented by Ingram  
(Company or Individual)

9) WATER LEVEL:  
Static level 175 ft. below land surface Date \_\_\_\_\_  
Artesian flow \_\_\_\_\_ gpm. Date \_\_\_\_\_

10) PACKERS: Type \_\_\_\_\_ Depth \_\_\_\_\_

11) TYPE PUMP:  
☐ Turbine ☐ Jet ☐ Submersible ☐ Cylinder  
☐ Other \_\_\_\_\_  
Depth to pump bowl, cylinder, jet, etc., \_\_\_\_\_ ft.

12) WELL TESTS:  
☐ Type Test ☐ Pump ☐ Bailor ☒ Jetted ☐ Estimated  
Yield: 55 gpm with \_\_\_\_\_ ft. drawdown after \_\_\_\_\_ hrs.

13) WATER QUALITY:  
Did you knowingly penetrate any strata which contained undesirable water? ☐ Yes ☒ No  
If yes, submit "REPORT OF UNDESIRABLE WATER"  
Type of water? \_\_\_\_\_ Depth of strata? \_\_\_\_\_  
Was a chemical analysis made? ☐ Yes ☒ No

I hereby certify that this well was drilled by me (or under my supervision) and that each and all of the statements herein are true to the best of my knowledge and belief.

NAME H. W. Schwope & Sons, Inc. Water Well Drillers Registration No. 1566  
(Type or Print)

ADDRESS PO Box 364 Boerne Texas 78006  
(Street or RFD) (City) (State) (Zip)

(Signed) [Signature] (Water Well Driller) (Company Name)

Please attach electric log, chemical analysis, and other pertinent information, if available.

MAP #14

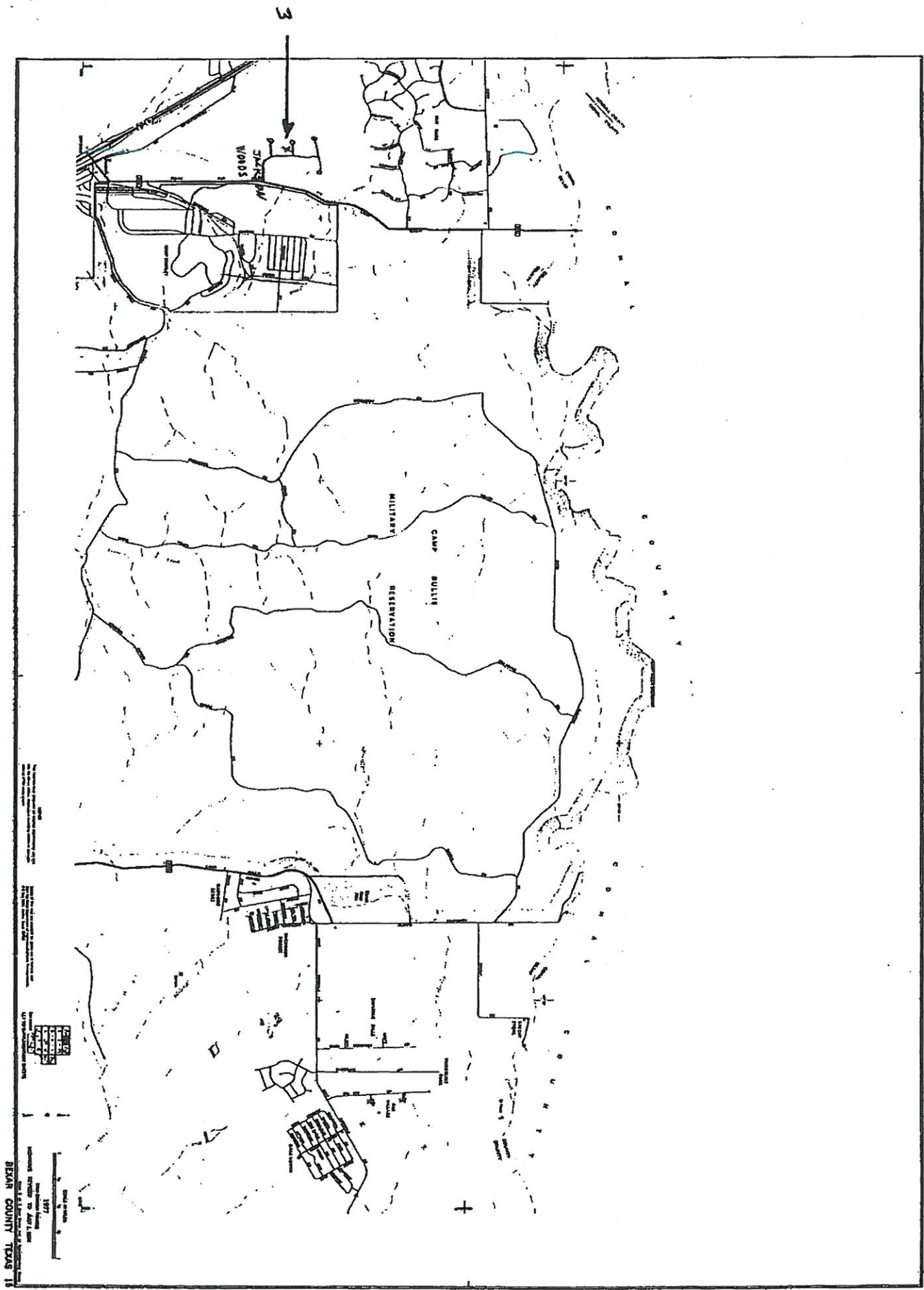

MAP# 14